

7. Ricaricare

Indicatore della batteria



* Accendi EasyGo per poter caricare



YOMPER+

Guida rapida

TRADUZIONE IN ITALIANO CONFORME ALLA VERSIONE ORIGINALE

1. Accendere



2. Agganciare

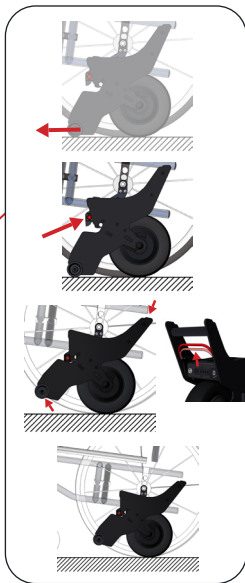

3. Posizionare

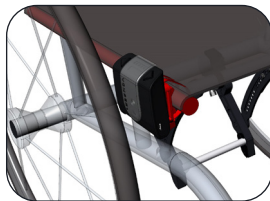
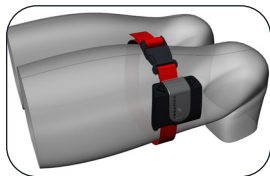

4. Connettere

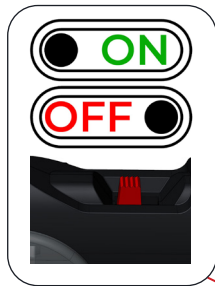

5. Controllo



6. Scegliere

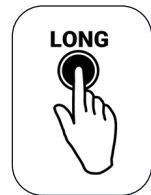

MODALITA'



MODALITÀ INDOOR



MODALITÀ OUTDOOR